

Sanoasa Comoda wellness benches

NEW Sanoasa Comoda | wellness benches, slope to front

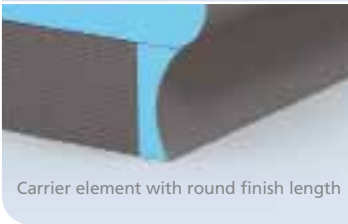

Carrier element with round finish length

Description	Length	Order no.
Sanoasa Comoda, bench element, slope to front	1000 mm	07-64-47/015
Sanoasa Comoda, bench element, slope to front	2000 mm	07-64-38/000
Sanoasa Comoda, carrier element, round finish length	1000 mm	07-64-37/500

Options

Bench element with integrated electrical heating set	2000 mm	–
Bench element with integrated hot water heating set	2000 mm	–

- ! The bench element is supplied in two parts, a back rest and a seat.
- These pieces shall be glued with wedi 610 sealant (Page 60), as must the bench element with the carrier element.
- Each bench element requires two carrier elements.
- For hot water or electrical heating sets which are to be installed on site, the delivery time is approx. 4–5 weeks.

m² Bench element (for 2000 mm length):

- Front: approx. 2.30 m²
- Rear panel: approx. 1.24 m²
- Sides: approx. 0.31 m²

Carrier elements (for 2000 mm length):

- Front: approx. 0.60 m²
- Rear panel: approx. 0.50 m²
- Sides: approx. 0.25 m²

Technical drawings

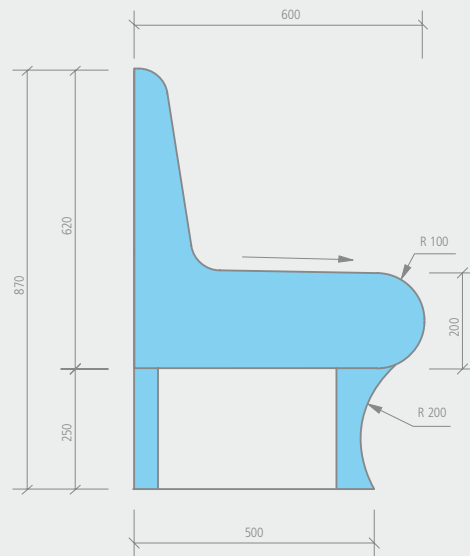

NEW Sanoasa Comoda *linea* | wellness bench, slope to front

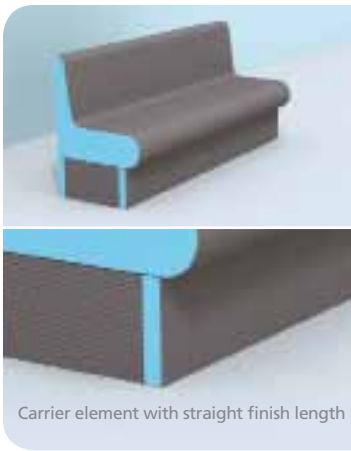

Description	Length	Order no.
Sanoasa Comoda, bench element, slope to front	1000 mm	07-64-47/015
Sanoasa Comoda, bench element, slope to front	2000 mm	07-64-38/000
Sanoasa Comoda <i>linea</i> , carrier element, straight finish length	1000 mm	07-64-37/000

Options		
Bench element with integrated electrical heating set	2000 mm	–
Bench element with integrated hot water heating set	2000 mm	–

- !** • The bench element is supplied in two parts, a back rest and a seat.
 - These pieces shall be glued with wedi 610 sealant (Page 60), as must the bench element with the carrier element.
 - Each bench element requires two carrier elements.
 - For hot water or electrical heating sets which are to be installed on site, the delivery time is approx. 4–5 weeks.
- m²** Bench element (for 2000 mm length):
 - Front: approx. 2.30 m²
 - Rear panel: approx. 1.24 m²
 - Sides: approx. 0.31 m²
 - Carrier elements (for 2000 mm length):
 - Front: approx. 0.50 m²
 - Rear panel: approx. 0.50 m²
 - Sides: approx. 0.25 m²

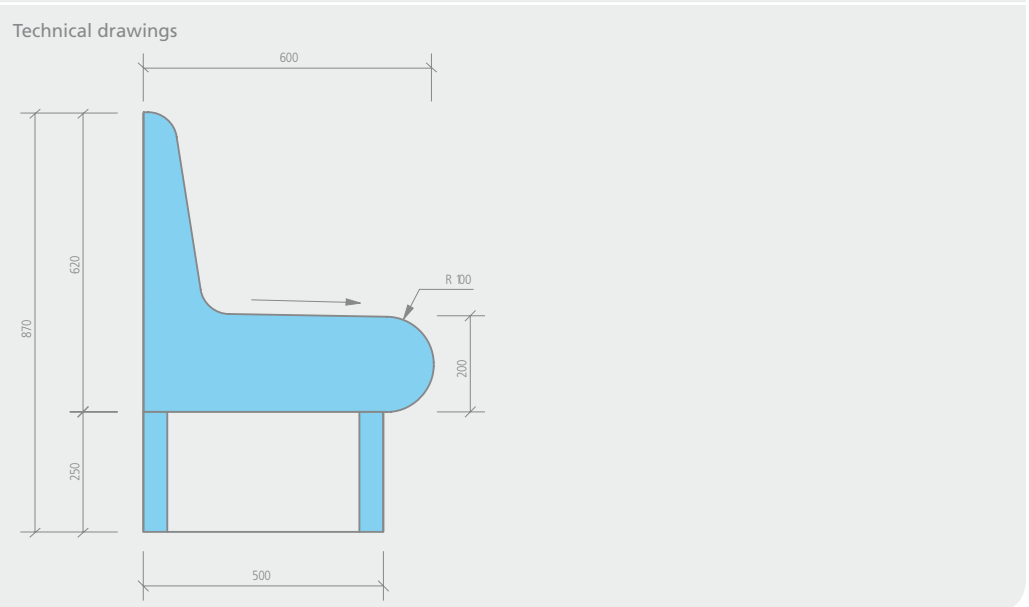

Sanoasa Comoda wellness benches

Sanoasa *Comoda linea* | corner element 90°, straight, slope to front

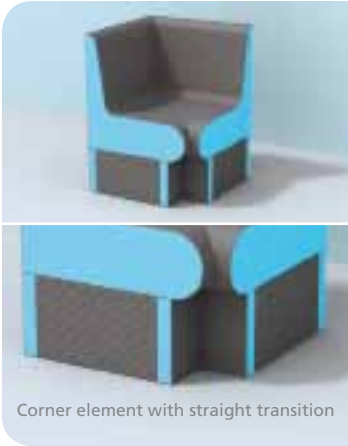

Corner element with straight transition

Description

Sanoasa Comoda, bench element 90°, straight, slope to front

Sanoasa Comoda *linea*, carrier corner element 90°

Length x width x height

Order no.

650 x 650 x 620 mm

07-64-47/004

650 x 650 x 250 mm

07-64-47/005

! • The bench element shall be glued to the carrier element using wedi 610, adhesive sealant (Page 60).

m² Bench corner element:

- Front: approx. 0.90 m²
- Rear panel: approx. 0.90 m²
- Sides: approx. 0.31 m²

Carrier corner element:

- Front: approx. 0.10 m²
- Rear panel: approx. 0.40 m²
- Sides: approx. 0.25 m²

Technical drawings

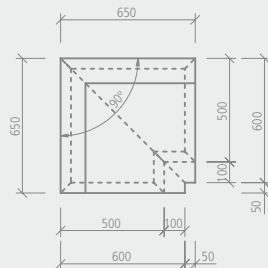
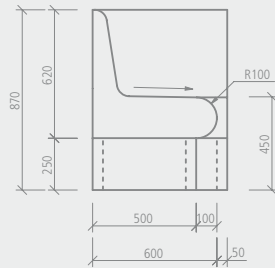

Sanoasa Comoda *linea* | corner element 90°, round, slope to front



Corner element with round transition

Description

Sanoasa Comoda, bench element 90°, round, slope to front

Sanoasa Comoda *linea*, carrier corner element 90°

Length x width x height

Order no.

850 x 850 x 620 mm

07-64-47/000

850 x 850 x 250 mm

07-64-47/001

! • The bench element shall be glued to the carrier element using wedi 610, adhesive sealant (Page 60).

m² Sanoasa Comodo corner element:

- Front: approx. 1.20 m²
- Rear panel: approx. 1.10 m²
- Sides: approx. 0.31 m²

Carrier corner element:

- Front: approx. 0.20 m²
- Rear panel: approx. 0.50 m²
- Sides: approx. 0.25 m²

Technical drawings

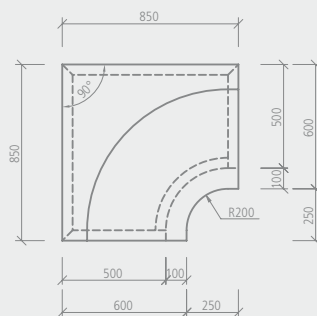
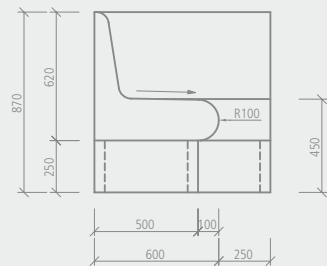

Sanoasa Comoda wellness benches

Sanoasa *Comoda linea* | corner element 135°, straight, slope to front

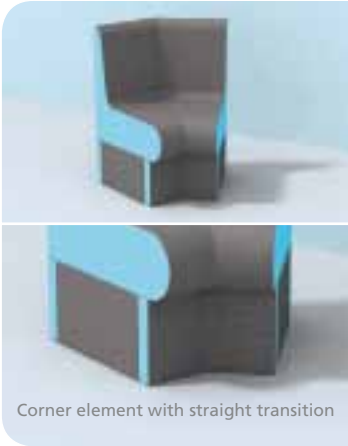

Description

Sanoasa Comoda, bench element 135°, straight, slope to front

Sanoasa Comoda *linea*, carrier corner element 135°

Length x width x height

Order no.

600 x 660 x 620 mm

07-64-47/006

660 x 500 x 250 mm

07-64-47/007

! The bench element shall be glued to the carrier element using wedi 610, adhesive sealant (Page 60).

m² Bench corner element:

- Front: approx. 0.80 m²
- Rear panel: approx. 0.50 m²
- Sides: approx. 0.31 m²

Carrier corner element:

- Front: approx. 0.10 m²
- Rear panel: approx. 0.20 m²
- Sides: approx. 0.25 m²

Technical drawings

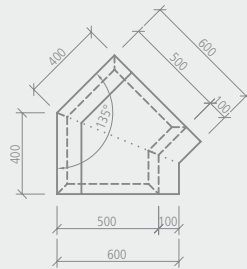
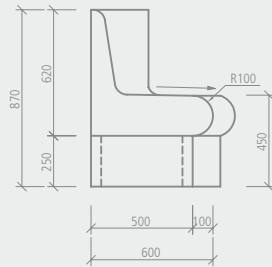

Sanoasa Comoda *linea* | corner element 135°, round, slope to front

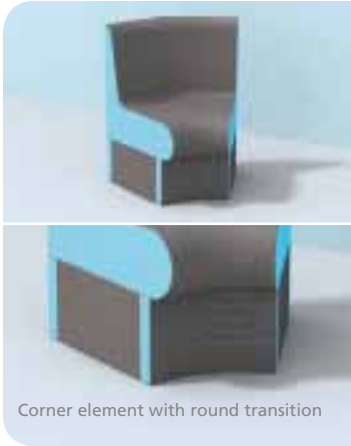

Corner element with round transition

Description

Sanoasa Comoda, bench element 135°, round, slope to front

Sanoasa Comoda *linea*, carrier corner element 135°

Length x width x height

Order no.

600 x 660 x 620 mm

07-64-47/002

660 x 500 x 250 mm

07-64-47/003

! • The bench element shall be glued to the carrier element using wedi 610, adhesive sealant (Page 60).

m² Bench corner element:

- Front: approx. 0.80 m²
- Rear panel: approx. 0.50 m²
- Sides: approx. 0.31 m²

Carrier corner element:

- Front: approx. 0.10 m²
- Rear panel: approx. 0.20 m²
- Sides: approx. 0.25 m²

Technical drawings

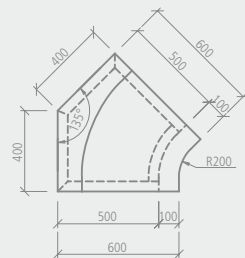
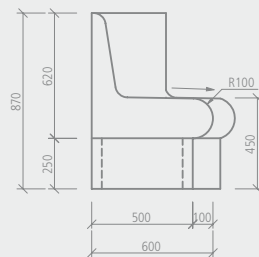

Sanoasa Comoda wellness benches

Sanoasa *Comoda linea* | end element, left, R=200, slope to front



Description

Sanoasa Comoda, bench end element left, R=200, slope to front

Sanoasa Comoda *linea*, carrier end element, R=200

Length x width x height

Order no.

600 x 300 x 620 mm

07-64-47/011

500 x 200 x 250 mm

07-64-47/013

! The bench element shall be glued to the carrier element using wedi 610, adhesive sealant (Page 60).

m² Bench end element:

- Front: approx. 0.60 m²
- Rear panel: approx. 0.20 m²
- Sides: approx. 0.31 m²

Carrier end element:

- Front: approx. 0.20 m²
- Rear panel: approx. 0.10 m²
- Sides: approx. 0.25 m²

Technical drawings

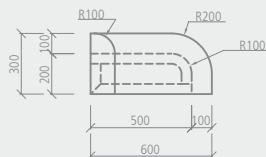
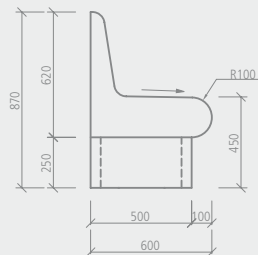

Sanoasa Comoda *linea* | end element, left, R=600, slope to front



Description

Sanoasa Comoda, bench end element left, R=600,
slope to front

Sanoasa Comoda *linea*, carrier end element, R=600

Length x width x height

Order no.

700 x 600 x 620 mm

07-64-47/008

600 x 500 x 250 mm

07-64-47/010

! • The bench element shall be glued to the carrier element using wedi 610, adhesive sealant (Page 60).

m² Bench end element:

- Front: approx. 0.80 m²
- Rear panel: approx. 0.30 m²
- Sides: approx. 0.31 m²

Carrier end element:

- Front: approx. 0.30 m²
- Rear panel: approx. 0.20 m²
- Sides: approx. 0.25 m²

Technical drawings

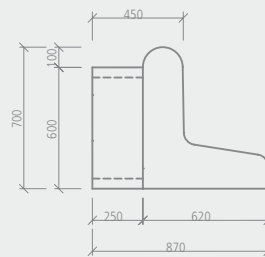
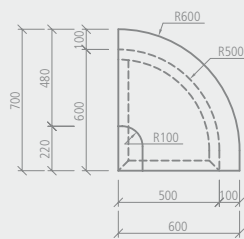
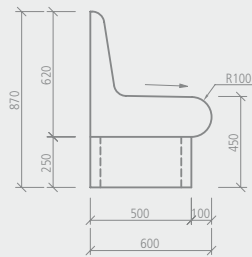

Sanoasa Comoda wellness benches

Sanoasa *Comoda linea* | end element, left, R=200, slope to front



Description

Sanoasa Comoda, bench end element left, R=200, slope to front

Sanoasa Comoda *linea*, carrier end element, R=200

Length x width x height

Order no.

600 x 300 x 620 mm

07-64-47/012

500 x 200 x 250 mm

07-64-47/013

! • The bench element shall be glued to the carrier element using wedi 610, adhesive sealant (Page 60).

m² Bench end element:

- Front: approx. 0.60 m²
- Rear panel: approx. 0.20 m²
- Sides: approx. 0.31 m²

Carrier end element:

- Front: approx. 0.20 m²
- Rear panel: approx. 0.10 m²
- Sides: approx. 0.25 m²

Technical drawings

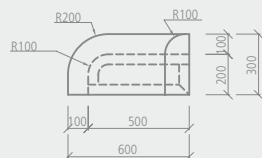
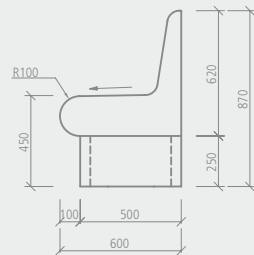

Sanoasa Comoda *linea* | end element, right, R=600, slope to front



Description	Length x width x height	Order no.
Sanoasa Comoda, bench end element left, R=600, slope to front	700 x 600 x 620 mm	07-64-47/009
Sanoasa Comoda <i>linea</i> , carrier end element, R=600	600 x 500 x 250 mm	07-64-47/010

! • The bench element shall be glued to the carrier element using wedi 610, adhesive sealant (Page 60).

m² Bench end element:

- Front: approx. 0.80 m²
- Rear panel: approx. 0.30 m²
- Sides: approx. 0.31 m²

Carrier end element:

- Front: approx. 0.30 m²
- Rear panel: approx. 0.20 m²
- Sides: approx. 0.25 m²

Technical drawings

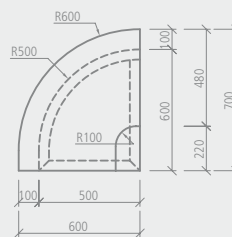
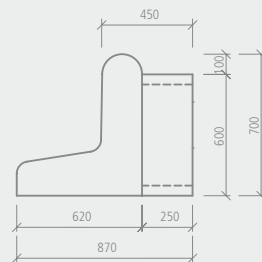
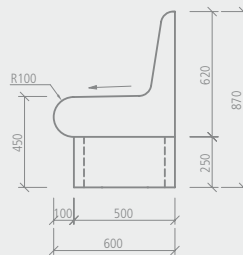

Sanoasa Comoda wellness benches

NEW Sanoasa Comoda | wellness benches, slope to back



Carrier element with round finish length

Description	Length	Order no.
Sanoasa Comoda, bench element, slope to back	1000 mm	07-64-47/016
Sanoasa Comoda, bench element, slope to back	2000 mm	07-64-36/000
Sanoasa Comoda, carrier element, round finish length	1000 mm	07-64-37/500

Options

Bench element with integrated electrical heating set	2000 mm	–
Bench element with integrated hot water heating set	2000 mm	–

- ! The bench element is supplied in two parts, a back rest and a seat.
- These pieces shall be glued with wedi 610 adhesive sealant (Page 60), as must the bench element with the carrier element.
- Each bench element requires two carrier elements.
- For hot water or electrical heating sets which are to be installed on site, the delivery time is approx. 4–5 weeks.

m² Bench element (for 2000 mm length):

- Front: approx. 2.30 m²
- Rear panel: approx. 1.24 m²
- Sides: approx. 0.30 m²

Carrier elements (for 2000 mm length):

- Front: approx. 0.60 m²
- Rear panel: approx. 0.50 m²
- Sides: approx. 0.25 m²

Technical drawings

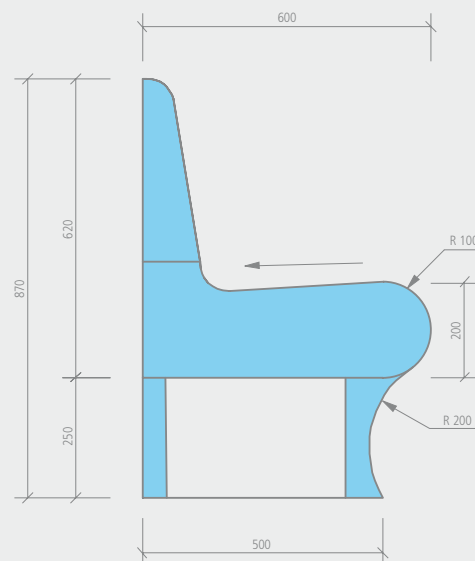

NEW Sanoasa Comoda *linea* | wellness bench, slope to back



Carrier element with straight finish length

Description	Length	Order no.
Sanoasa Comoda, bench element, slope to back	1000 mm	07-64-47/016
Sanoasa Comoda, bench element, slope to back	2000 mm	07-64-36/000
Sanoasa Comoda <i>linea</i> , carrier element, straight finish length	1000 mm	07-64-37/000

+ Options

Bench element with integrated electrical heating set	2000 mm	–
Bench element with integrated hot water heating set	2000 mm	–

- !** • The bench element is supplied in two parts, a back rest and a seat.
- These pieces shall be glued with wedi 610 adhesive sealant (Page 60), as must the bench element with the carrier element.
- Each bench element requires two carrier elements.
- For hot water or electrical heating sets which are to be installed on site, the delivery time is approx. 4–5 weeks.

m² Bench element (for 2000 mm length):

- Front: approx. 2.30 m²
- Rear panel: approx. 1.24 m²
- Sides: approx. 0.30 m²

Carrier elements (for 2000 mm length):

- Front: approx. 0.50 m²
- Rear panel: approx. 0.50 m²
- Sides: approx. 0.25 m²

Technical drawings

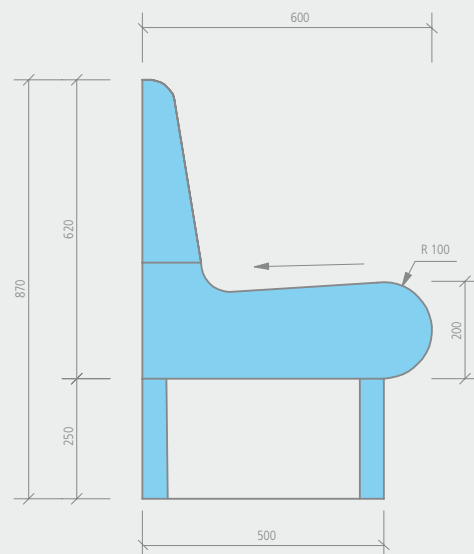

Sanoasa Comoda wellness benches

Sanoasa Comoda & Comoda *linea* | armrest



Description	Length x width x height	Order no.
Sanoasa Comoda & Comoda <i>linea</i> , armrest	650 x 105 x 870 mm	07-64-47/014

- !** The Sanoasa Comoda & Comoda *linea* armrest can be installed equally on the right or the left.
- The armrest must be glued to the bench element and carrier element using wedi 610 adhesive sealant (Page 60).

m ² Armrest:	
• Front:	approx. 0.75 m ²
• Rear panel:	approx. 0.10 m ²
• Sides:	approx. 0.90 m ²

Technical drawings

